



21 First Avenue

Little Lever, Bolton, Lancashire, BL3 1DG

Offers In Excess Of
£130,000

Property Features

- 2 BEDROOM TERRACE FOR SALE
 - NO UPWARD CHAIN
 - FULLY REFURBISHED
 - POTENTIAL INVESTMENT OPPORTUNITY
 - DOUBLE GLAZED THROUGHOUT
 - TWO DOUBLE BEDROOMS
 - IDEAL FOR FIRST TIMES BUYERS
 - FREEHOLD
-

STEP INSIDE

The property has received an impressive refurbishment throughout. This could be your first home or it is a landlords dream property, due to our inclusive landlord package more on that later.

This lovely home consists of an entrance hallway, leading to the spacious open plan lounge/diner and kitchen to rear. The kitchen leads out into the secure rear garden.

From the dining room into kitchen located to the rear aspect, featuring a range of high gloss white wall and base units with complementary work surfaces, space for a washing machine, free standing cooker and fridge freezer.

Up the staircase where you will find the two bedrooms that will both accommodate a double bed and ample additional furnishings. Also, on this floor is the beautiful family bathroom which is all brand new and comes with 3 piece suite and an electric shower with glass screen.

To the front of the property there is a grassed area with surrounding fence panels and overlooks the greenery.

To the rear of the property there is the low maintenance garden, featuring a flagged patio area, storage shed and access to the back via a rear gate.

Please Note: This property is located in a pedestrianised square making it extremely safe for children. There is



plenty of parking available on the perimeter just a 10 second walk from the house.

This property really needs to be seen to fully appreciate the finish and effort that has been lovingly taken with this property.

Are you a landlord looking for a "turn key" investment? Then this is the property for you.

Freehold property

Council tax band - A

EPC (Energy Performance Certificate) rating - C

LOCATION

Located on Sixth Avenue, on the outskirts of Little Lever, this property is positioned close to a number of facilities briefly including, Moses Gate Country Park which is also known as Crompton Lodges. Here you can enjoy a nice walk around the lodge or visit the children's adventure park. The Jolly Carter is within walking distance of the property, serving food and offering live sports coverage. Within a short distance of the property you will find Bowness Primary School & Little Lever Secondary School, ideal for all you busy parents rushing off to work. There is a petrol station and convenience store located on the main road and you can access the local bus route leading into Bolton, Radcliffe and Farnworth.

PROPERTY PARTICULARS DISCLAIMER

Property particulars as supplied by Hannon Holmes Estate Agents are set out as a general outline in accordance with the Property Misdescriptions Act (1991) only for the guidance of intending purchasers or lessees, and do not constitute any part of an offer or contract. Details are given without any responsibility, and any intending purchasers, lessees or third parties should not rely on them as statements or representations of fact, but must satisfy themselves by inspection or otherwise as to the correctness of each of them. We have not carried out a structural survey and the services, appliances and specific fittings have not been tested. All photographs, measurements, floor plans and distances referred to are given as a guide only and should not be relied upon for the purchase of



carpets or any other fixtures or fittings. Gardens, roof terraces, balconies and communal gardens as well as tenure and lease details cannot have their accuracy guaranteed for intending purchasers. Lease details, service ground rent (where applicable) are given as a guide only and should be checked and confirmed by your solicitor prior to exchange of contracts. No person in the employment of Hannon Holmes Ltd has any authority to make any representation or warranty whatever in relation to this property. Purchase prices, rents or other prices quoted are correct at the date of publication and, unless otherwise stated, exclusive of VAT. TENURE : The type of tenure has been given to us by the seller. This has not been verified. The Agent has not checked the legal documents to verify the tenure status of the property. The buyer is advised to obtain verification from their Solicitor or Surveyor.



Ground Floor

Approx. 31.5 sq. metres (338.7 sq. feet)

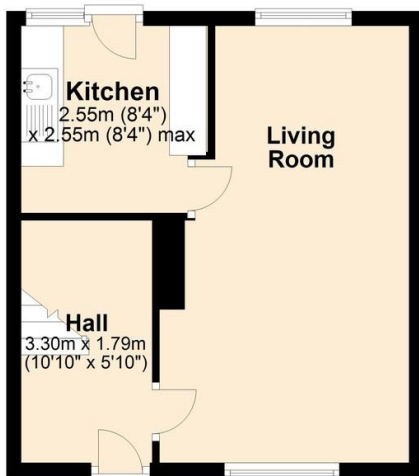

First Floor

Approx. 31.5 sq. metres (338.7 sq. feet)

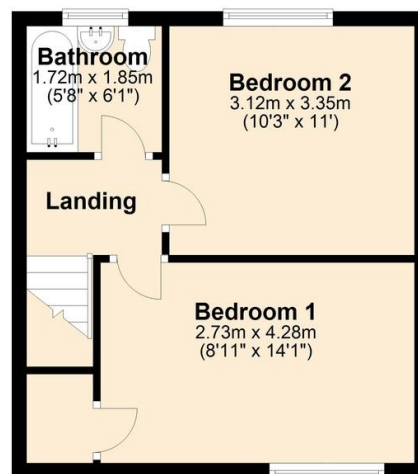

Total area: approx. 62.9 sq. metres (677.5 sq. feet)

79 - 81 Market
Street
Little Lever
Bolton
Lancashire

www.hannonholmes.co.uk
info@hannonholmes.co.uk
01204 793113

Agents Note: Whilst every care has been taken to prepare these particulars, they are for guidance purposes only. All measurements are approximate and whilst every care has been taken to ensure their accuracy, they should not be relied upon and potential buyers/tenants are advised to recheck the measurements